

# Коммутаторы серии ЕКІ-25 ХХ, 27 ХХ, 65 ХХ, 76 ХХ, 93 ХХ

## ТЕХНИЧЕСКИЕ ХАРАКТЕРИСТИКИ

**По вопросам продаж и поддержки обращайтесь:**

Архангельск (8182)63-90-72  
Астана +7(7172)727-132  
Белгород (4722)40-23-64  
Брянск (4832)59-03-52  
Владивосток (423)249-28-31  
Волгоград (844)278-03-48  
Вологда (8172)26-41-59  
Воронеж (473)204-51-73  
Екатеринбург (343)384-55-89  
Иваново (4932)77-34-06  
Ижевск (3412)26-03-58  
Казань (843)206-01-48

Калининград (4012)72-03-81  
Калуга (4842)92-23-67  
Кемерово (3842)65-04-62  
Киров (8332)68-02-04  
Краснодар (861)203-40-90  
Красноярск (391)204-63-61  
Курск (4712)77-13-04  
Липецк (4742)52-20-81  
Магнитогорск (3519)55-03-13  
Москва (495)268-04-70  
Мурманск (8152)59-64-93  
Набережные Челны (8552)20-53-41

Нижний Новгород (831)429-08-12  
Новокузнецк (3843)20-46-81  
Новосибирск (383)227-86-73  
Орел (4862)44-53-42  
Оренбург (3532)37-68-04  
Пенза (8412)22-31-16  
Пермь (342)205-81-47  
Ростов-на-Дону (863)308-18-15  
Рязань (4912)46-61-64  
Самара (846)206-03-16  
Санкт-Петербург (812)309-46-40  
Саратов (845)249-38-78

Смоленск (4812)29-41-54  
Сочи (862)225-72-31  
Ставрополь (8652)20-65-13  
Тверь (4822)63-31-35  
Томск (3822)98-41-53  
Тула (4872)74-02-29  
Тюмень (3452)66-21-18  
Ульяновск (8422)24-23-59  
Уфа (347)229-48-12  
Челябинск (351)202-03-61  
Череповец (8202)49-02-64  
Ярославль (4852)69-52-93

# EKI-2525P

# EKI-2525PA

# EKI-2526PI

## 5-port Industrial PoE Switch

## 5-port Industrial PoE Switch with 24/48 V<sub>DC</sub> Power Input

## 6-port Industrial PoE Switch with Wide Temperature



### Features

- Provides 5/6 Fast Ethernet ports with 4 PoE ports with injector function
- Supports 10/100Mbps Auto Negotiation
- Provides broadcast storm protection
- Supports Ethernet ESD protection
- Provides surge (EFT) protection 3,000 V<sub>DC</sub> for power line
- Provides Slim size, DIN-rail/Wallmount with IP30 metal mechanism
- Supports Redundant 48 V<sub>DC</sub> power input and P-Fail relay (EKI-2525P/EKI-2526PI)
- Supports Redundant 24/48 V<sub>DC</sub> power input and P-Fail Relay (EKI-2525PA)
- Supports operating temperatures from -10 ~ 60° C (EKI-2525P/EKI-2525PA)
- Supports wide operating temperature -40 ~ 75° C (EKI-2526PI)

### Introduction

The EKI-2525P/EKI-2525PA is a 5-port unmanaged PoE (Power-over-Ethernet) Industrial Ethernet switch and EKI-2526PI is a 6-port unmanaged PoE Industrial Ethernet switch, they support 4 PoE ports which are classified as power source equipments (PSE). The PoE devices makes centralized power supply come true and provides up to 15.4 watts of power per port. Advantech EKI PoE devices can be used to power IEEE802.3af compliant powered devices (PD) by Ethernet cable and eliminates the need for additional power wiring. Advantech EKI PoE devices come equipped with all the standard features of the EKI family. Furthermore, it offers a 48 V<sub>DC</sub> redundant power input design (EKI-2525P/EKI-2526PI) and 24/48 V<sub>DC</sub> redundant power input design (EKI-2525PA), and is secured with a double protection mechanism; Power Polarity Reverse Protect and an Overload Current Resettable Fuse. Advantech EKI PoE devices come with compact metal housing that rates IP30 to help against from dusty industrial environments.

### Specifications

#### Communications

- Standard** IEEE 802.3, 802.3u, 802.3x, 802.3af
- LAN** 10/100Base-TX
- Transmission Distance** Up to 100 m
- Transmission Speed** Up to 100 Mbps

#### Interface

- Connectors** PoE Ports: 4 (Ports 1 ~ 4)  
Ethernet x1 (EKI-2525P/EKI-2525PA)  
Ethernet x2 (EKI-2526PI)  
6-pin removable screw terminal (power & relay)
- LED Indicators** P1, P2, P-Fail  
10/100TX: Link/Activity, Duplex/Collision

#### Power

- Power Consumption** EKI-2525P: 65 W (Full load PoE)  
EKI-2525PA: 62.5 W (Full load PoE)  
EKI-2526PI: 62.6 W (Full load PoE)
- Power Input** 48 V<sub>DC</sub> (EKI-2525P/EKI-2526PI), redundant dual inputs  
24/48 V<sub>DC</sub> (EKI-2525PA), redundant dual inputs
- Power Output** 15.4 W at 48V (per PoE port)
- Fault Output** 1 Relay Output

#### Mechanism

- Dimensions (W x H x D)** 37 x 140 x 95 mm (EKI-2525P)  
48.6 x 140 x 95 mm (EKI-2525PA/EKI-2526PI)
- Enclosure** IP30, Metal shell with solid mounting kits
- Mounting** DIN-rail, Panel

#### Protection

- ESD (Ethernet)** 4,000 V<sub>DC</sub>
- Surge (EFT for power)** 3,000 V<sub>DC</sub>
- Reverse Polarity** Present
- Overload** EKI-2525P: 3 A @ 48 V<sub>DC</sub>  
EKI-2525PA: 5 A @ 24/48 V<sub>DC</sub>  
EKI-2526PI: 3.5 A @ 48 V<sub>DC</sub>

#### Environment

- Operating Temperature** -10 ~ 60° C (14 ~ 140° F) (EKI-2525P/EKI-2525PA)  
Wide temp. model  
-40 ~ 75° C (-40 ~ 167° F) (EKI-2526PI)
- Storage Temperature** -40 ~ 85° C (-40 ~ 185° F)
- Operating Humidity** 5 ~ 95% (non-condensing)
- Storage Humidity** 0 ~ 95% (non-condensing)
- MTBF** 440,132 hrs

#### Certifications

- Safety** UL 60950-1, CAN/CSA-C22.2 No.60950  
U.S.A.: FCC Part 15 CISPR 22
- EMC** EU: EN55011, EN61000-6-4  
EN55022 Class A,  
EN61000-3-2/3  
EN55024  
IEC61000-4-2/3/4/5/6/8  
EN61000-6-2
- Shock** IEC60068-2-27
- Freefall** IEC60068-2-32
- Vibration** IEC60068-2-6

### Ordering Information

- EKI-2525P** 5-port PoE Switch
- EKI-2525PA** 5-port PoE Switch 24/48 V<sub>DC</sub> Power Input
- EKI-2526PI** 6-port PoE Switch w/ Wide Temp

# EKI-2701PSI

## Industrial Ethernet PoE Splitter with Wide Temperature

NEW



CE FCC UL

### Features

- Supports 10/100/1000T for PoE in and Data out
- IEEE802.3af compliant split power/data from PoE equipment
- Power Isolation and short circuit protection for power output
- Supports output power up to 12.95W at 24VDC
- Provides slim size and DIN-rail/Wallmount with IP30 metal mechanism
- Supports operating temperatures from -40 ~ 75° C
- Provides EFT protection 3000 VDC for power line
- Supports 4000 VDC Ethernet ESD protection

### Introduction

With the technology of PoE (Power over Ethernet), we can transfer both data and electrical power to Ethernet-enabled devices using a standard Ethernet CAT5 cable, EKI-2701PSI plays the role of powered device (PD) and splits power from PoE to Ethernet devices. In this case, both power and data can be transmitted up to 328 feet (100m) from power source equipment (PSE). This product can operate in a wide range of temperature between -40 and 75 °C, and the rugged hardware design makes EKI-2701PSI perfect to ensure your PoE Ethernet equipment can meet industrial applications demanding.

### Specifications

#### Communications

- **Standard** IEEE 802.3, 802.3u, 802.3x, 802.3af
- **LAN** 100Base-TX, 10/1000Base-T
- **Transmission Distance** Up to 100 m
- **Transmission Speed** Up to 100 Mbps

#### Interface

- **Connectors** PoE IN : RJ-45  
DATA OUT : RJ-45  
6-pin removable screw terminal (power output)
- **LED Indicators** Power  
Link/Activity, Duplex/Collision

#### Power

- **Power Consumption** 17.76W @ 48VDC
- **Power Input** +44 ~ 57 VDC
- **Power Output** 12.95W @ 24VDC

#### Mechanism

- **Dimensions (WxHxD)** 37 x 140 x 95 mm
- **Enclosure** IP30, Metal shell with solid mounting kits
- **Mounting** DIN-rail, Wall

#### Protection

- **ESD (Ethernet)** 4,000 V<sub>DC</sub>
- **Surge (EFT for power)** 3,000 V<sub>DC</sub>
- **Overload** 0.539A @ 24VDC

#### Environment

- **Operating Temperature** -40~75° C (-40~167° F)
- **Storage Temperature** -40~85° C (-40~185° F)
- **Operating Humidity** 5 ~ 95% (non-condensing)
- **Storage Humidity** 0 ~ 95% (non-condensing)
- **MTBF** 440,132 hrs

#### Certifications

- **Safety (1000 Mbps)** UL 60950-1, CAN/CSA-C22.2 No.60950
- **EMC** U.S.A.: FCC Part 15 CISPR 22  
EU: EN55011, EN61000-6-4  
EN55022 Class A,  
EN61000-3-2/3  
EN55024  
IEC61000-4-2/3/4/5/6/8  
EN61000-6-22/4
- **Shock** IEC60068-2-27
- **Freefall** IEC60068-2-32
- **Vibration** IEC60068-2-6

### Ordering Information

- **EKI-2701PSI** Industrial Ethernet PoE Splitter, Wide Temp.

# EKI-7659CPI

## 8+2G Port Gigabit Managed Redundant Industrial PoE Switch with Wide Temperature



### Features

- 2 Gigabit Copper/SFP combo ports, plus 8 PoE injector ports
- SFP socket for Easy and Flexible Fiber Expansion
- Redundancy: Gigabit X-Ring (ultra high-speed recovery time < 10ms), RSTP/STP (802.1w/1D)
- Management: Web, Telnet, Serial Console, SNMP
- Control: VLAN/GVRP, QoS, IGMP Snooping/Query, LACP, Rate Limit
- Security: IP/MAC and port binding, DHCP Server, IP access list, 802.1X, SNMPv3
- Diagnostic: Port Statistic, Port Mirroring, RMON, Trap, Email Alert, Syslog
- Dual 48 V<sub>DC</sub> power input and 1 relay output
- Supports wide operating temperatures from -40 ~ 75° C

### Introduction

EKI-7659CPI supports 8 Power over Ethernet (PoE) ports and 2 Gigabit combo ports. The PoE device helps realize a centralized power supply solution and provides up to 15.4 watts of power per port. To create reliability in your network, the EKI-7659CPI comes equipped with a proprietary redundant network protocol -- X-Ring that was developed by Advantech, which provides users with an easy way to establish a redundant Ethernet network with ultra high-speed recovery time less than 10 ms. Furthermore, EKI-7659CPI also supports many advanced network standards to optimize network performance, ease maintenance issues, and secure network safety.

### Specifications

#### Communications

- **Standard** IEEE 802.3, 802.3u, 802.3x, 802.3z, 802.1d, 802.1w, 802.1p, 802.1Q, 802.1x, 802.3ad, 802.3ab, 802.3af, 10/100/1000Base-T(X), Optional 100Base-FX, 1000Base-SX/LX/LHX/XD/ZX/EZX
- **LAN**
- **Transmission Distance** Ethernet: Up to 100 m (4-wire Cat.5e, Cat.6 RJ-45 cable suggested for Gigabit port)  
SFP: Up to 110 km (depends on SFP)
- **Transmission Speed** Ethernet: 10/100Mbps Auto-Negotiation  
Gigabit Copper: 10/100/1000 Mbps, Auto-Negotiation  
Gigabit Fiber: Up to 1000 Mbps

#### Interface

- **Connectors** 8 x RJ-45 (Ethernet)  
2 x RJ-45/SFP (mini-GBIC) combo ports  
6-pin removable screw terminal (Power&Relay)
- **LED Indicators** System: PWR, PWR1, PWR2, R.M., P-Fail  
10/100T(X): Link/Activity, Duplex/Collision  
Gigabit Copper: Link/Activity, Speed (1000Mbps)  
SFP: Link/Activity
- **Console** RS-232 (RJ-45)

#### Network Management

- **Configuration** Web browser, Telnet, Serial console, TFTP, SNMPv1/v2c/v3, Port Speed/Duplex Configuration
- **VLAN** IEEE 802.1Q, GVRP, Port-based VLAN
- **Redundancy** ADVANTECH X-Ring (Recovery time < 10ms at 30pcs full loading ring structure), Dual Homing, Couple Ring, 802.1w/D RSTP/STP
- **Security** IP Access security, port security, DHCP Server, Port and IP Binding, 802.1X Port Access Control
- **Traffic Control** IGMP Snooping/Query for multicast group management Port Trunking, Static/802.3ad LACP Rate limit and storm control  
IEEE 802.1p QoS CoS/TOS/DSCP priority queuing  
IEEE 802.3x flow control
- **Diagnostics** Port Mirroring, Real-time traffic statistic, MAC Address Table, SNTP, Syslog, E-Mail Alert, SNMP Trap, RMON

#### Mechanism

- **Enclosure** IP30, metal shell with solid mounting kits
- **Dimensions (W x H x D)** 79 x 152 x 105 mm
- **Mounting** DIN-rail, wall

#### Power

- **Power Consumption** 116 W (Full Load)
- **Power Input** 48 V<sub>DC</sub>, redundant dual power input
- **Power Output** 15.4W at 48V (per PoE port)
- **Fault Output** 1 Relay Output

#### Protection

- **ESD (Ethernet)** 4,000 V<sub>DC</sub>
- **Surge (EFT for power)** 3,000 V<sub>DC</sub>
- **Power Reverse** Present
- **Overload** 3.5 A @ 12 V<sub>DC</sub> (Fuse)

#### Environment

- **Operating Temperature** -40 ~ 75° C (-40 ~ 167° F)
- **Storage Temperature** -40 ~ 85° C (-40 ~ 185° F)
- **Operating Humidity** 5 ~ 95% (non-condensing)
- **Storage Humidity** 0 ~ 95% (non-condensing)
- **MTBF** 284,409 hours

#### Certifications

- **Safety** UL 60950-1, CAN/CSA-C22.2 No.60950
- **EMC** EU: EN55011, EN61000-6-4, EN55022 Class A, EN61000-3-2/3, EN55024, IEC61000-4-2/3/4/5/6/8, EN61000-6-2
- **Shock** IEC60068-2-27
- **Freefall** IEC60068-2-32
- **Vibration** IEC60068-2-6

### Ordering Information

- **EKI-7659CPI** 8+2G Giga Managed PoE Switch w/Wide Temp

# EKI-6528TI

# EKI-6528TPI

**EN50155 8-port M12 Unmanaged Switch with Wide Temperature**

**EN50155 8-port M12 Unmanaged PoE Switch with Wide Temperature**



## Features

- Auto Bypass between Port 1 and Port 2
- EN50155 certified
- Wide redundant power design
- 8-port 10/100 Mbps M12 type connector with IP40 protection
- 4-port PoE type M12 (EKI-6528TPI)
- Dual redundant power input
- Supports wide operating temperature -40 ~ 75°C

## Introduction

EKI-6528TI and EKI-6528TPI are EN50155 certified industrial switches with IP40 protection and wide temperature support designed for railway applications. EKI-6528TPI provides four PoE ports that support IEEE 802.3af and can provide up to 15.4 watts of power per port. M12 connectors ensure highly reliable connectivity for industrial communication applications. With IP40 compact metal housings, these switches are protected against dusty environments and are a good fit for many industrial applications. Under no-power condition, 'Auto Bypass' function ensures the Ethernet signal connection through internal circuitry. This feature provides non-stop communication to rolling stocks even no power exists in some of the carriages.

## Specifications

### Communications

- **Standard** IEEE 802.3  
IEEE 802.3u  
IEEE 802.3x  
IEEE 802.3af
- **LAN** 10/100Base-T (X)
- **Transmission Speed** Up to 100 Mbps

### Interface

- **Ethernet** M12, 4-pole D-coded, Female x 8

### Mechanism

- **Enclosure** IP40 protected metal shell
- **Dimensions (W x H x D)** 92 x 180 x 42 mm (3.62" x 7.08" x 1.65")
- **Mounting** DIN-rail, Wall

### Power

- **Power Consumption** Max. 3.36 W (EKI-6528TI)  
Max. 72 W (EKI-6528TPI)
- **Power Input** 24 ~ 48 V<sub>DC</sub>, redundant dual inputs (for EKI-6528TPI)  
12 ~ 48 V<sub>DC</sub>, redundant dual inputs (for EKI-6528TI)
- **Power Connector** M12, 5-pole A-coded, male x 1
- **P-Fail Output** 1A @ 24 V<sub>DC</sub>
- **P-Fail Connector** M12, 8-pole A-coded, Female x 1

### Protection

- **Power Reverse** Present
- **Overload Current** Present

### Environment

- **Operating Temperature** -40 ~ 75°C (-40 ~ 167°F)
- **Storage Temperature** -40 ~ 85°C (-40 ~ 185°F)
- **Operating Humidity** 5 ~ 95% (non-condensing)
- **Storage Humidity** 0 ~ 95% (non-condensing)
- **MTBF** 391,307 hours (EKI-6528TI)  
348,384 hours (EKI-6528TPI)

### Certification

- **Safety** UL 60950-1
- **EMI** FCC Part 15 Subpart B Class A, EN 55022 Class A
- **EMS** EN 61000-4-2  
EN 61000-4-3  
EN 61000-4-4  
EN 61000-4-5  
EN 61000-4-6  
EN 61000-4-8
- **Shock** IEC 61373
- **Freefall** IEC 60068-2-32
- **Vibration** IEC 61373
- **Railway** EN50155, EN 50121-3-2, EN 50121-4

## Dimensions

Unit: [mm]

### EKI-6528TI

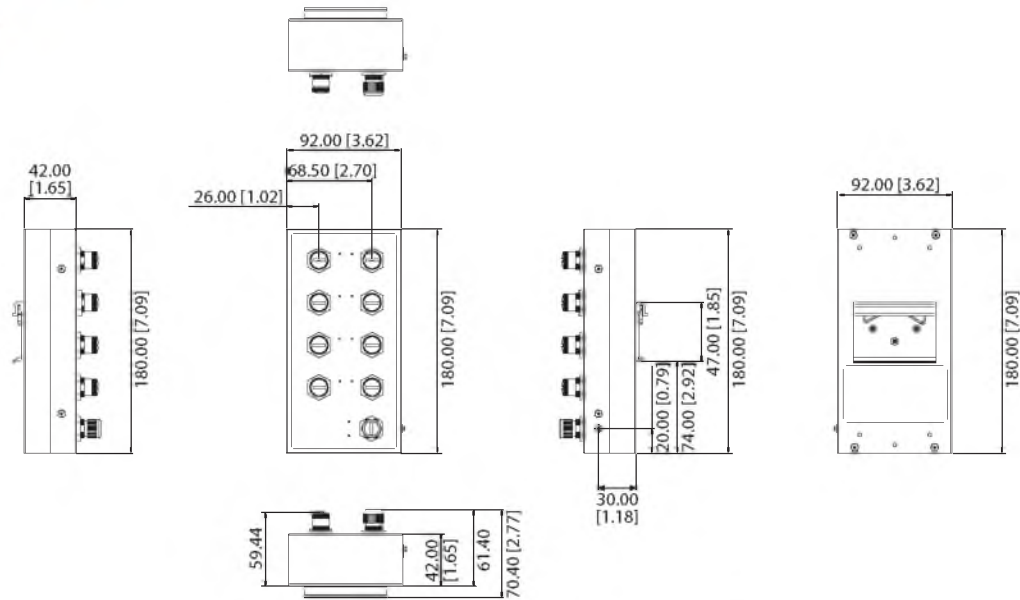

**Panel Cut-out Dimensions: 92.00 x 180.00 x 42.00 mm (3.62" x 7.09 x 1.65")**

### EKI-6528TPI

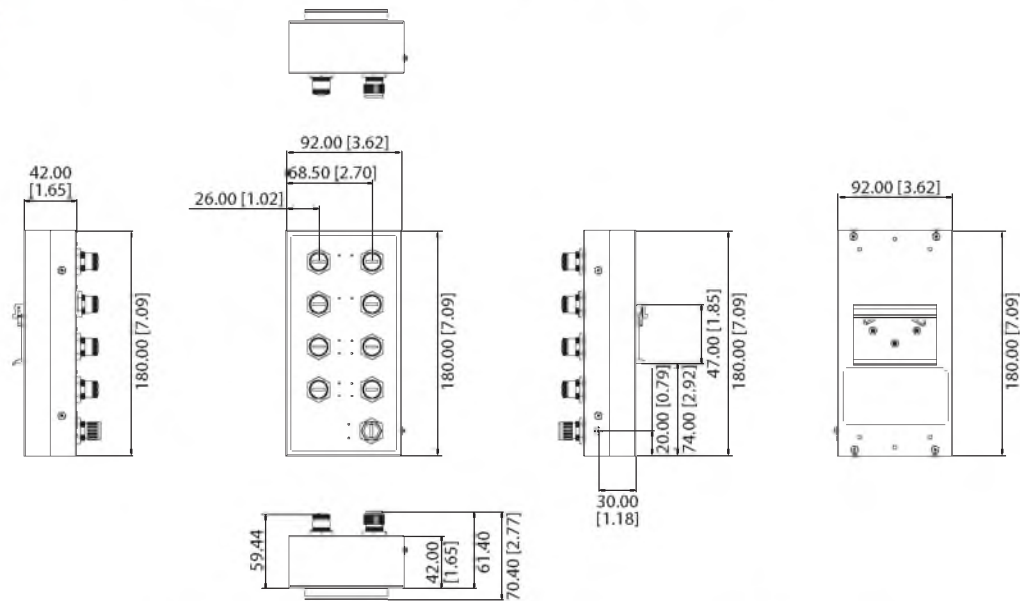

**Panel Cut-out Dimensions: 92.00 x 180.00 x 42.00 mm (3.62" x 7.09 x 1.65")**

## Ordering Information

- EKI-6528TI EN50155 8-port M12 Unmanaged Ethernet Switch
- EKI-6528TPI EN50155 8-port M12 Unmanaged PoE Switch

# EKI-2525PA

# EKI-2528PAI

**5-port Industrial PoE Switch with 24/48 V<sub>DC</sub> Power Input**

**8-port Industrial PoE Switch with 24/48 V<sub>DC</sub> Power Input and Wide Temperature**



## Features

- Provides 5/8 Fast Ethernet ports with 4 PoE ports with injector function
- Supports 10/100 Mbps Auto Negotiation
- Provides broadcast storm protection
- Supports Ethernet ESD protection
- Provides power line EFT protection
- Provides slim size, DIN-rail/Wall mount with IP30 metal mechanism
- Supports Redundant 24/48 V<sub>DC</sub> power input and P-Fail Relay
- Supports operating temperatures from -10 to 60°C (EKI-2525PA)
- Supports wide operating temperature -40 ~ 75°C (EKI-2528PAI)

## Introduction

The EKI-2525PA and EKI-2528PAI are a 5/8-port unmanaged PoE (Power-over-Ethernet) Industrial Ethernet switches that supports 4 PoE ports which are classified as power source equipment (PSE). These PoE devices make centralized power supply possible and provide up to 15.4 watts of power per port. Advantech EKI PoE devices can be used to power IEEE 802.3af compliant powered devices (PD) through Ethernet cable and eliminate the need for additional power wiring. Advantech EKI PoE devices come equipped with all the standard features of the EKI family. Furthermore, they offer a 24/48 V<sub>DC</sub> redundant power input design and is secured with a double protection mechanism; Power Polarity Reverse Protect and an Overload Current Resettable Fuse. Advantech EKI PoE devices come with compact metal housing that rates IP30 to help against from dusty industrial environments.

## Specifications

### Communications

- **Standard** IEEE 802.3, 802.3u, 802.3x, 802.3af
- **LAN** 10/100Base-T (X)
- **Transmission Distance** Up to 100 m
- **Transmission Speed** Up to 100 Mbps

### Interface

- **Connectors** PoE Ports: 4 (Ports 1 ~ 4)  
Ethernet ports: 1 (Port 5 ~ Port 8), EKI-2525PA  
Ethernet ports: 4 (Port 5 ~ Port 8), EKI-2528PAI  
6-pin removable screw terminal (power & relay)
- **LED Indicators** P1, P2, P-Fail  
10/100TX: Link/Activity, Duplex/Collision

### Power

- **Power Consumption** EKI-2525PA: 62.5 W (Full load PoE)  
EKI-2528PAI: 65 W (Full load PoE)
- **Power Input** 24/48 V<sub>DC</sub>, redundant dual inputs
- **Power Output** 15.4 W at 48 V (per PoE port)
- **Fault Output** 1 Relay Output

### Mechanism

- **Dimensions (W x H x D)** 48.6 x 140 x 95 mm (1.91" x 5.51" x 3.74")
- **Enclosure** IP30, Metal shell with solid mounting kits
- **Mounting** DIN-rail, Wall

### Protection

- **Reverse Polarity** Present
- **Overload current** Present

### Environment

- **Operating Temperature** -10 ~ 60°C (14 ~ 140°F) (EKI-2525PA)  
Wide temp. model -40 ~ 75°C (-40 ~ 167°F) (EKI-2528PAI)
- **Storage Temperature** -40 ~ 85°C (-40 ~ 185°F)
- **Operating Humidity** 5 ~ 95% (non-condensing)
- **Storage Humidity** 0 ~ 95% (non-condensing)
- **MTBF** 440,132 hours

### Certification

- **Safety** UL508
- **EMI** FCC Part 15 Subpart B Class A, EN 55022 Class A
- **EMS** EN 61000-4-2  
EN 61000-4-3  
EN 61000-4-4  
EN 61000-4-5  
EN 61000-4-6  
EN 61000-4-8
- **Shock** IEC 60068-2-27
- **Freefall** IEC 60068-2-32
- **Vibration** IEC 60068-2-6

## Dimensions

Unit: [mm]

### EKI-2525PA

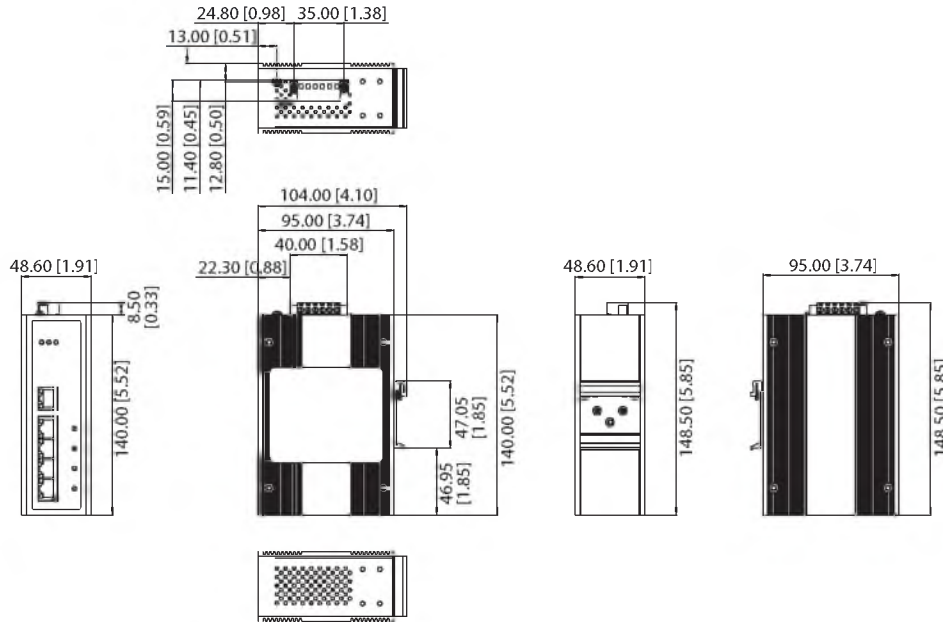

**Panel Cut-out Dimensions: 104 x 140 x 48.6 mm (4.1" x 5.52" x 1.91")**

### EKI-2528PAI

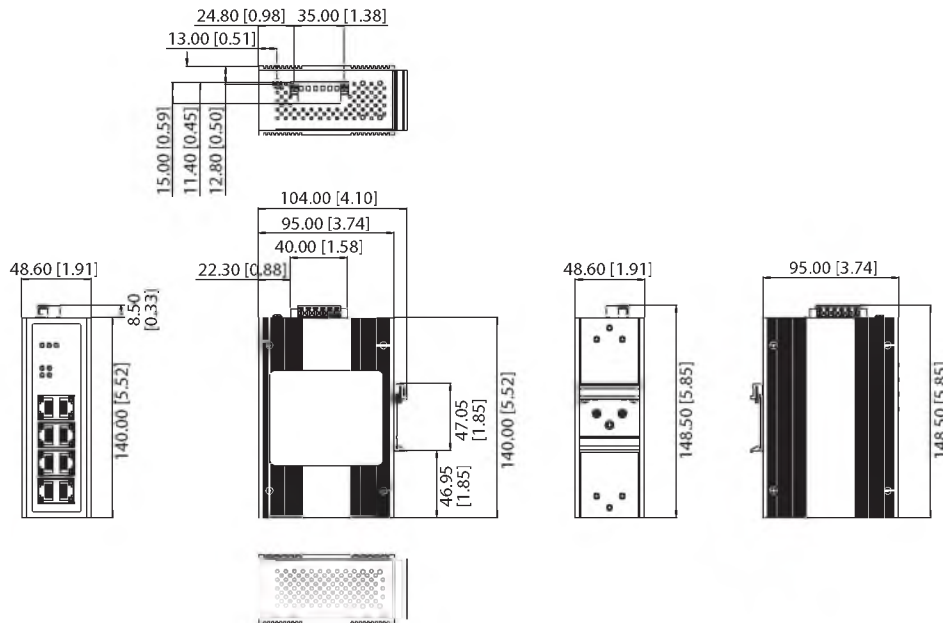

**Panel Cut-out Dimensions: 104 x 140 x 48.6 mm (4.1" x 5.52" x 1.91")**

## Ordering Information

- **EKI-2525PA** 5-port Switch with 4 port-PoE and 24/48 V<sub>DC</sub> Power Input
- **EKI-2528PAI** 8-port Switch with 4 port-PoE and 24/48 V<sub>DC</sub> Power Input (Wide Temp)



# EKI-9312P

## Industrial-Class 12 Port Managed DIN Rail Switch Full Gigabit Switch with PoE/PoE+

NEW



FC CE

### Features

- All Gigabit connections support dual ring protection and non-blocking traffic forwarding
- X-Ring+: recovery time within 20ms for 250 node connections
- IEEE 802.3at PoE+ to supply 30W power
- IEEE 802.3af PoE to supply 15.4 power
- IEEE 802.3af/802.3at per port with system PoE power management
- Dual power input, dual image for system reliability
- Operating temperature: -40 ~ 75°C

### Introduction

The EKI-9312P Gigabit managed PoE+ Ethernet switches come standard with 8 10/100/1000BaseT(X), 802.3af (PoE), and 802.3at (PoE+) compliant Ethernet ports, and 4 fiber optic Gigabit Ethernet ports. The EKI-9312P PoE Ethernet switches provide up to 30 watts of power per PoE+ port for heavy-duty, industrial PoE devices, such as weather-proof IP surveillance cameras, high performance wireless access points, and rugged IP phones.

The EKI-9312P are equipped with 8 Gigabit Ethernet ports and up to 4 fiber optic ports, making them ideal for upgrading an existing network to Gigabit speed or building a new, full Gigabit network. The X-Ring+ with RSTP, STP and MSTP support, increases system reliability and the availability of your network. The EKI-9312P are designed especially for bandwidth demanding applications, such as video and process monitoring, intelligent transportation systems, all of which benefit from a scalable backbone construction.

### Specifications

#### Interface

- **I/O Port** 8 x 10/100/1000Base-T/TX RJ-45  
4 x 1000BASE-X SFP
- **Console port** RJ-45
- **F/W backup port** USB
- **Power Connector** 6-pin screw Terminal Block (including relay)

#### Physical

- **Enclosure** Aluminum Shell
- **Protection Class** IP 30
- **Installation** DIN Rail
- **Dimensions (W x H x D)** 86 x 165 x 125 (mm)

#### LED Display

- **System LED** PWR1, PWR2, SYS, CFG, Alarm and R.M.
- **Port LED** Link / Speed / Activity / PoE

#### Environment

- **Operating Temperature** -40 ~ 75°C
- **Storage Temperature** -40 ~ 85°C
- **Ambient Relative Humidity** 10 ~ 95% (non-condensing)
- **Humidity** 10 ~ 95% (non-condensing)

#### Power

- **Power Consumption** ~ 21.82 Watts (System)  
EKI-9316P: ~294.22 Watts  
EKI-9312P: ~203.42 Watts
- **Power Input** 48 (46 to 57 V) V<sub>DC</sub> dual inputs  
(> 53 V<sub>DC</sub> for PoE+ output recommended)

#### Certification

- **EMI** CE, FCC Class A
- **Safety** UL60950 C1D2
- **EMC** EN61000-6-4; EN61000-6-2; EN61000-4-2 (ESD) Level 4 EN61000-4-3 (RS) Level 3; EN61000-4-4 (EFT) Level 4; EN50121-4; EN61000-4-5 (Surge) Level 4; EN61000-4-6 (CS) Level 3 EN61000-4-8 (Magnetic Field) Level 4
- **Shock** IEC 60068-2-27
- **Freefall** IEC 60068-2-32
- **Vibration** IEC 60068-2-6

#### L2 Features

- **L2 MAC Address** 16K
- **Jumbo Frame** 12KB
- **VLAN Group** 4K (VLAN ID 1-4094)
- **VLAN Arrange** Mac based VLAN, Protocol based VLAN, IP subnet based VLAN, Port based VLAN, Q-in-Q (VLAN Stacking), GVRP
- **Port Mirroring** Per port, Multi-source port, RSAPN.
- **IP Multicast** IGMP Snooping v1/v2/v3, MLD Snooping, IGMP Immediate leave
- **Storm Control** Broadcast, Multicast, Unknown unicast
- **Spanning Tree** IEEE 802.1D-STP, IEEE 802.1s-MSTP, IEEE 802.1w-RSTP, X-Ring+

## Dimensions

Unit: mm

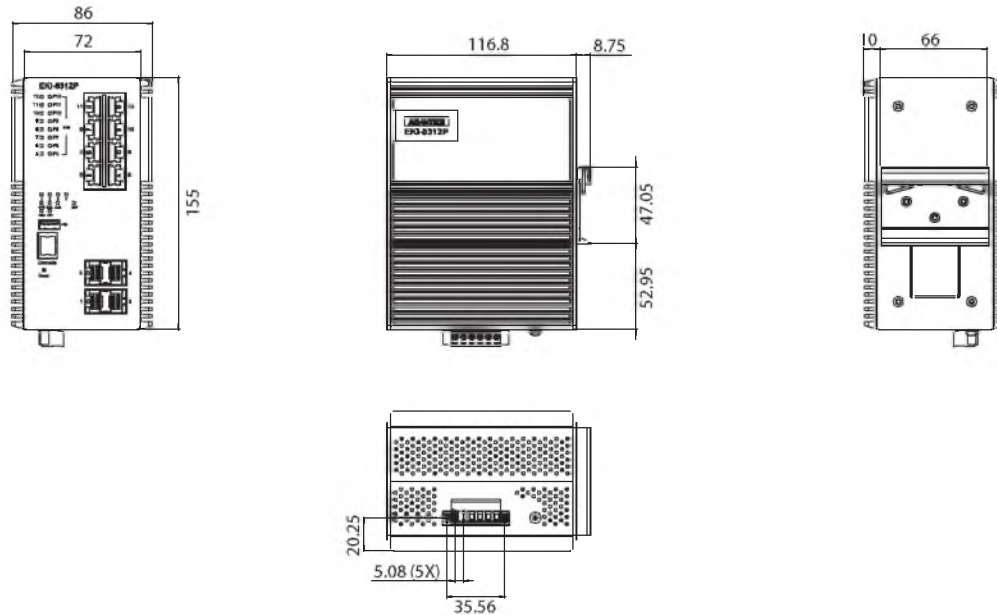

### QoS

- **Priority Queue Scheduling** WRR (Weighted Round Robin), SP (Strict Priority), Hybrid Priority
- **Class of Service** IEEE 802.1p Based CoS, IP TOS, DSCP based CoS
- **Rate Limiting** Ingress Rate limit, Egress Rate limit
- **Link Aggregation** IEEE 802.3ad Dynamic Port Trunking, Static Port Trunking

### Security

- **Port Security** Static, Dynamic
- **Authentication** 802.1x (Port-Based, MAC-Based, MD5/TLS/TTLS/PEAP Encryption), RADIUS, TCACAS+
- **ACL** 1K rules
- **Advanced Security** IP Source guard, ARP inspection, DHCP Snooping

### Management

- **DHCP** Client, Server, Relay, Option66/67/82
- **Access** SNMP v1/v2c/v3, WEB, Telnet, RMON, Standard MIB, Private MIB
- **Security access** SSH2.0, SSL
- **Software upgrade** TFTP, HTTP, Dual Image
- **NTP** NTP client/server

## Ordering Information

- **EKI-9312-POID42E** Layer 2 Fastpath, 8 x GbE 100/1000Base-T with PoE+ 4 x GbE SFP w/ 48 V<sub>DC</sub> Redundant Power Input

Contact our sales for more pricing & ordering information.

# EKI-9316P

## Industrial-Class 16 Port Managed DIN Rail Switch Full Gigabit Switch with PoE/PoE+

NEW



FC CE

### Features

- All Gigabit connections support dual ring protection and non-blocking traffic forwarding
- X-Ring+: recovery time within 20ms for 250 node connections
- IEEE 802.3at PoE+ to supply 30W power
- IEEE 802.3af PoE to supply 15.4 power
- IEEE 802.3af/802.3at per port with system PoE power management
- Dual power input, dual image for system reliability
- Operating temperature: -40 ~ 75°C

### Introduction

The EKI-9316P Gigabit managed PoE+ Ethernet switches come standard with 12 10/100/1000Base-T(TX) RJ-45, 802.3af (PoE), and 802.3at (PoE+) compliant Ethernet ports, and 4 fiber optic Gigabit Ethernet ports. The EKI-9316P PoE Ethernet switches provide up to 30 watts of power per PoE+ port for heavy-duty, industrial PoE devices, such as weather-proof IP surveillance cameras, high performance wireless access points, and rugged IP phones.

The EKI-9316P are equipped with 12 Gigabit Ethernet ports and up to 4 fiber optic ports, making them ideal for upgrading an existing network to Gigabit speed or building a new, full Gigabit network. The X-Ring+ with RSTP, STP and MSTP support, increases system reliability and the availability of your network. The EKI-9316P are designed especially for bandwidth demanding applications, such as video and process monitoring, intelligent transportation systems, all of which benefit from a scalable backbone construction.

### Specifications

#### Interface

- **I/O Port** 12 x 10/100/1000Base-T/TX RJ-45  
4 x 1000 BASE-X SFP
- **Console port** RJ-45
- **F/W backup port** USB
- **Power Connector** 6-pin screw Terminal Block (including relay)

#### Physical

- **Enclosure** Aluminum Shell
- **Protection Class** IP 30
- **Installation** DIN Rail
- **Dimensions (W x H x D)** 86 x 165 x 125 (mm)

#### LED Display

- **System LED** PWR1, PWR2, SYS, CFG, Alarm and R.M.
- **Port LED** Link / Speed / Activity / PoE

#### Environment

- **Operating Temperature** -40 ~ 75°C
- **Storage Temperature** -40 ~ 85°C
- **Ambient Relative Humidity** 10 ~ 95% (non-condensing)
- **Humidity** 10 ~ 95% (non-condensing)

#### Power

- **Power Consumption** ~ 21.82 Watts (System)  
EKI-9316P: ~294.22 Watts  
EKI-9312P: ~203.42 Watts
- **Power Input** 48 (46 to 57 V) V<sub>DC</sub> dual inputs  
(> 53 V<sub>DC</sub> for PoE+ output recommended)

#### Certification

- **EMI** CE, FCC Class A
- **Safety** UL60950 C1D2
- **EMC** EN61000-6-4; EN61000-6-2; EN61000-4-2 (ESD) Level 4 EN61000-4-3 (RS) Level 3; EN61000-4-4 (EFT) Level 4 EN61000-4-5 (Surge) Level 4; EN61000-4-6 (CS) Level 3 EN61000-4-8 (Magnetic Field) Level 4; EN50121-4
- **Shock** IEC 60068-2-27
- **Freefall** IEC 60068-2-32
- **Vibration** IEC 60068-2-6

#### L2 Features

- **L2 MAC Address** 16K
- **Jumbo Frame** 12KB
- **VLAN Group** 4K (VLAN ID 1-4094)
- **VLAN Arrange** Mac based VLAN, Protocol based VLAN, IP subnet based VLAN, Port based VLAN, Q-in-Q (VLAN Stacking), GVRP
- **Port Mirroring** Per port, Multi-source port, RSPAN.
- **IP Multicast** IGMP Snooping v1/v2/v3, MLD Snooping, IGMP Immediate leave
- **Storm Control** Broadcast, Multicast, Unknown unicast
- **Spanning Tree** IEEE 802.1D-STP, IEEE 802.1s-MSTP, IEEE 802.1w-RSTP, X-Ring+

## Dimensions

Unit: mm

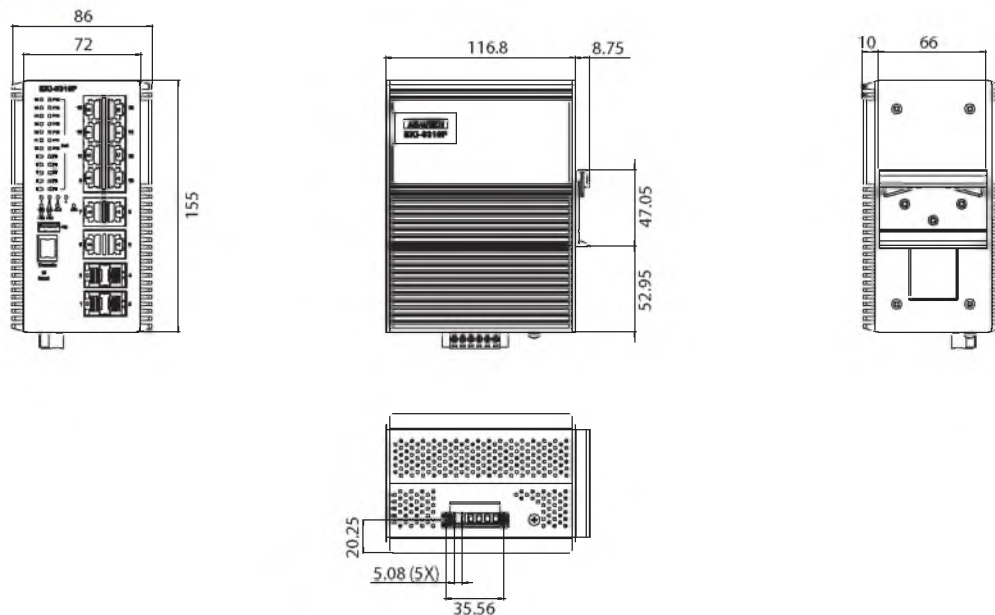

### QoS

- **Priority Queue Scheduling** WRR (Weighted Round Robin), SP (Strict Priority), Hybrid Priority
- **Class of Service** IEEE 802.1p Based CoS, IP TOS, DSCP based CoS
- **Rate Limiting** Ingress Rate limit, Egress Rate limit
- **Link Aggregation** IEEE 802.3ad Dynamic Port Trunking, Static Port Trunking

### Security

- **Port Security** Static, Dynamic
- **Authentication** 802.1x (Port-Based, MAC-Based, MD5/TLS/TTLS/PEAP Encryption), RADIUS, TCACAS+
- **ACL** 1K rules
- **Advanced Security** IP Source guard, ARP inspection, DHCP Snooping

### Management

- **DHCP** Client, Server, Relay, Option66/67/82
- **Access** SNMP v1/v2c/v3, WEB, Telnet, RMON, Standard MIB, Private MIB
- **Security access** SSH2.0, SSL
- **Software upgrade** TFTP, HTTP, Dual Image
- **NTP** NTP client/server

## Ordering Information

- **EKI-9316-POID42E** Layer 2 Fastpath, 12 x GbE 100/1000Base-T with PoE+ 4 x GbE SFP w/ 48V<sub>CC</sub> Redundant Power Input

Contact our sales for more pricing & ordering information.

**По вопросам продаж и поддержки обращайтесь:**

Архангельск (8182)63-90-72  
Астана +7(7172)727-132  
Белгород (4722)40-23-64  
Брянск (4832)59-03-52  
Владивосток (423)249-28-31  
Волгоград (844)278-03-48  
Вологда (8172)26-41-59  
Воронеж (473)204-51-73  
Екатеринбург (343)384-55-89  
Иваново (4932)77-34-06  
Ижевск (3412)26-03-58  
Казань (843)206-01-48

Калининград (4012)72-03-81  
Калуга (4842)92-23-67  
Кемерово (3842)65-04-62  
Киров (8332)68-02-04  
Краснодар (861)203-40-90  
Красноярск (391)204-63-61  
Курск (4712)77-13-04  
Липецк (4742)52-20-81  
Магнитогорск (3519)55-03-13  
Москва (495)268-04-70  
Мурманск (8152)59-64-93  
Набережные Челны (8552)20-53-41

Нижний Новгород (831)429-08-12  
Новокузнецк (3843)20-46-81  
Новосибирск (383)227-86-73  
Орел (4862)44-53-42  
Оренбург (3532)37-68-04  
Пенза (8412)22-31-16  
Пермь (342)205-81-47  
Ростов-на-Дону (863)308-18-15  
Рязань (4912)46-61-64  
Самара (846)206-03-16  
Санкт-Петербург (812)309-46-40  
Саратов (845)249-38-78

Смоленск (4812)29-41-54  
Сочи (862)225-72-31  
Ставрополь (8652)20-65-13  
Тверь (4822)63-31-35  
Томск (3822)98-41-53  
Тула (4872)74-02-29  
Тюмень (3452)66-21-18  
Ульяновск (8422)24-23-59  
Уфа (347)229-48-12  
Челябинск (351)202-03-61  
Череповец (8202)49-02-64  
Ярославль (4852)69-52-93